



 ROBINSONS

Douglas Crescent

Dunstable, LU5 5AT

Asking Price £595,000

- DETACHED
- THREE RECEPTION ROOMS
- SECRET GARDEN AREA
- IDEAL FOR A LARGE FAMILY
- EXCELLENT
- FIVE/SIX BEDROOMS
- LARGE PLOT
- BAY FRONTED
- UTILITY ROOM
- DOWNSTAIRS BEDROOM WITH SHOWER ROOM

Floor Plan

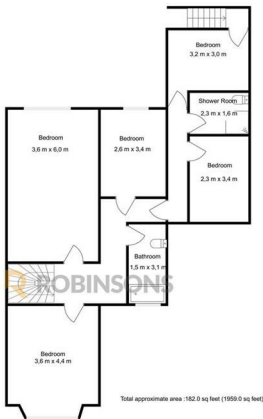

Floorplan produced by Woodside Photography
Floorplan is for illustration purposes only and all measurements are approximate

Area Map



Energy Efficiency Graph

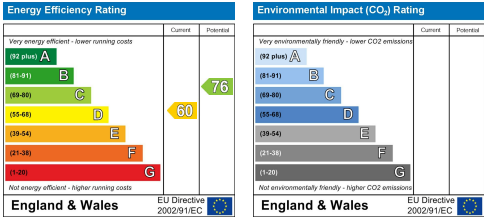

These particulars, whilst believed to be accurate are set out as a general outline only for guidance and do not constitute any part of an offer or contract. Intending purchasers should not rely on them as statements of representation of fact, but must satisfy themselves by inspection or otherwise as to their accuracy. No person in this firms employment has the authority to make or give any representation or warranty in respect of the property.

20 West Street, Dunstable,
Bedfordshire, LU6 1SX

20 West Street, Dunstable,
Bedfordshire, LU6 1SX

robinsons-estates.co.uk
sales@robinsons-estates.co.uk