



 ROBINSONS

Enfield Close

Dunstable, LU5 5PL

£285,000

- GARAGE
- COMPLETE UPPER CHAIN
- IMMACULATELY PRESENTED
- CLOSE TO M1 TRANSPORT LINKS
- COMBI BOILER
- CLOAKROOM
- THREE BEDROOMS
- IDEAL FIRST TIME BUY
- IDEALLY LOCATED TO LOCAL AMENITIES
- EXCELLENT STORAGE

Floor Plan

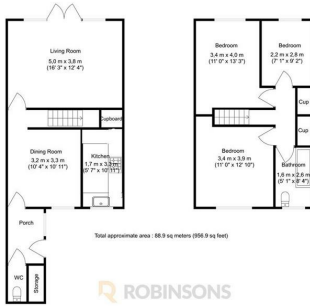

ROBINSONS

Floorplan produced by Woodside Photography
Floorplan for Robinsons purposes only and all measurements are approximate

Area Map



Energy Efficiency Graph

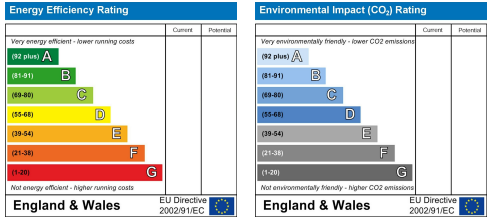

ROBINSONS



ROBINSONS



ROBINSONS



ROBINSONS

These particulars, whilst believed to be accurate are set out as a general outline only for guidance and do not constitute any part of an offer or contract. Intending purchasers should not rely on them as statements of representation of fact, but must satisfy themselves by inspection or otherwise as to their accuracy. No person in this firm's employment has the authority to make or give any representation or warranty in respect of the property.

20 West Street, Dunstable,
Bedfordshire, LU6 1SX

20 West Street, Dunstable,
Bedfordshire, LU6 1SX

robinsons-estates.co.uk
sales@robinsons-estates.co.uk